

COMPUTER FREEHOLD REGISTER UNDER LAND TRANSFER ACT 1952



R. W. Muir
Registrar-General
of Land

Search Copy

Identifier **WN9C/915**
Land Registration District **Wellington**
Date Issued 18 November 1971

Prior References

WN784/21

Estate Fee Simple
Area 708 square metres more or less
Legal Description Lot 4 Deposited Plan 10005

Proprietors

James Robert Thomas and Janete Thomas

Interests

B016613.1 Mortgage to BNZ Finance Limited - 21.7.1989 at 2:10 pm
B472413.2 Variation of Mortgage B016613.1 - 17.10.1995 at 2:42 pm
8345231.1 Variation of Mortgage B016613.1 - 15.3.2010 at 10:15 am

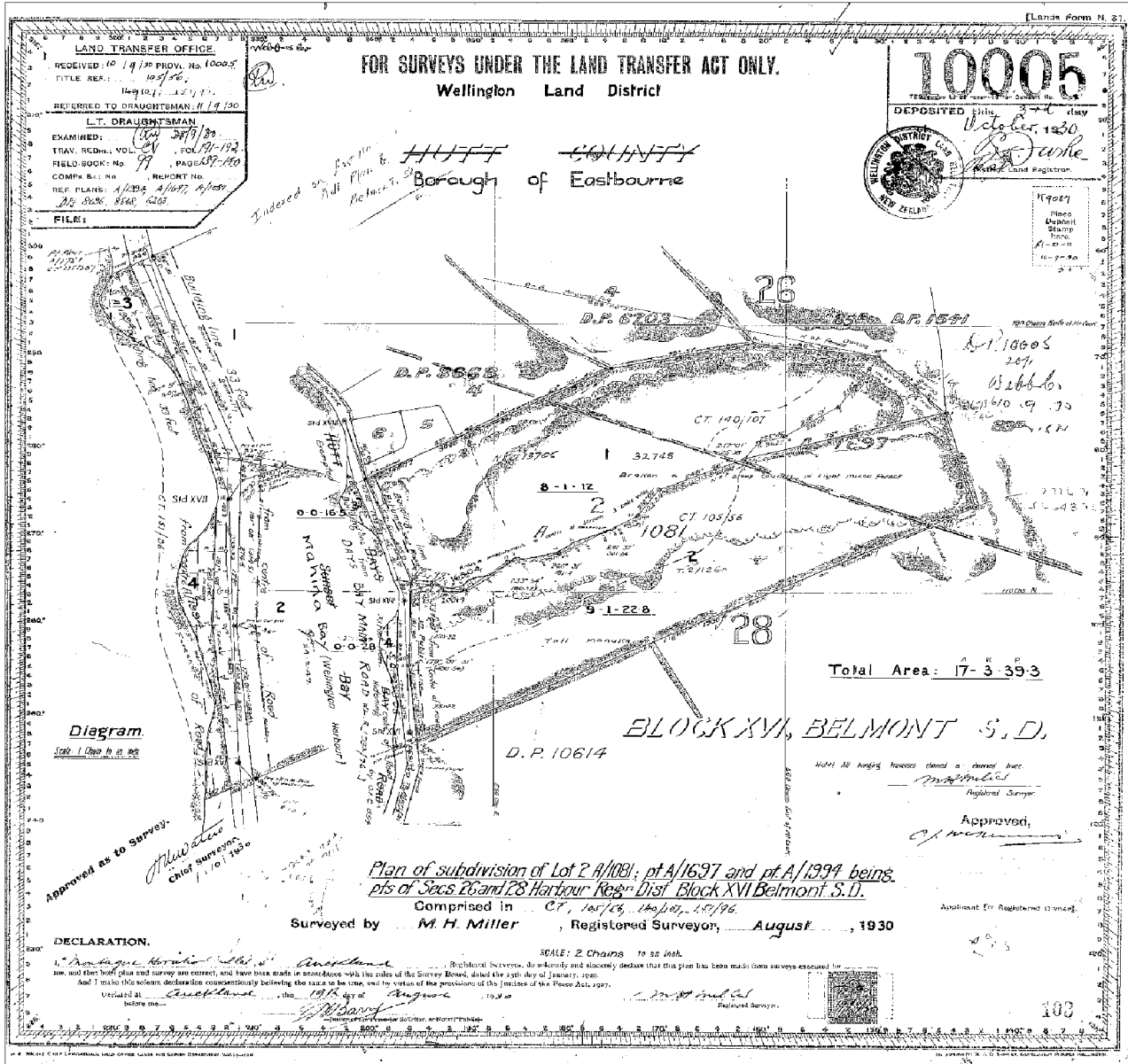

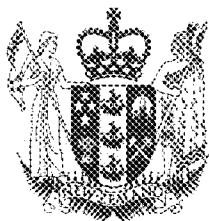

**RECORD OF TITLE
UNDER LAND TRANSFER ACT 2017
FREEHOLD
Search Copy**



R.W. Muir
Registrar-General
of Land

Identifier **WN37D/408**
Land Registration District **Wellington**
Date Issued 25 June 1990

Prior References

WN6D/1426

Estate Fee Simple
Area 3364 square metres more or less
Legal Description Section 1 Survey Office Plan 31984

Registered Owners

Centreport Limited

Interests

Subject to a right of access (in gross) in favour of The Hutt City Council created by Transfer B812379.1 - 24.11.2000 at 3.43 pm

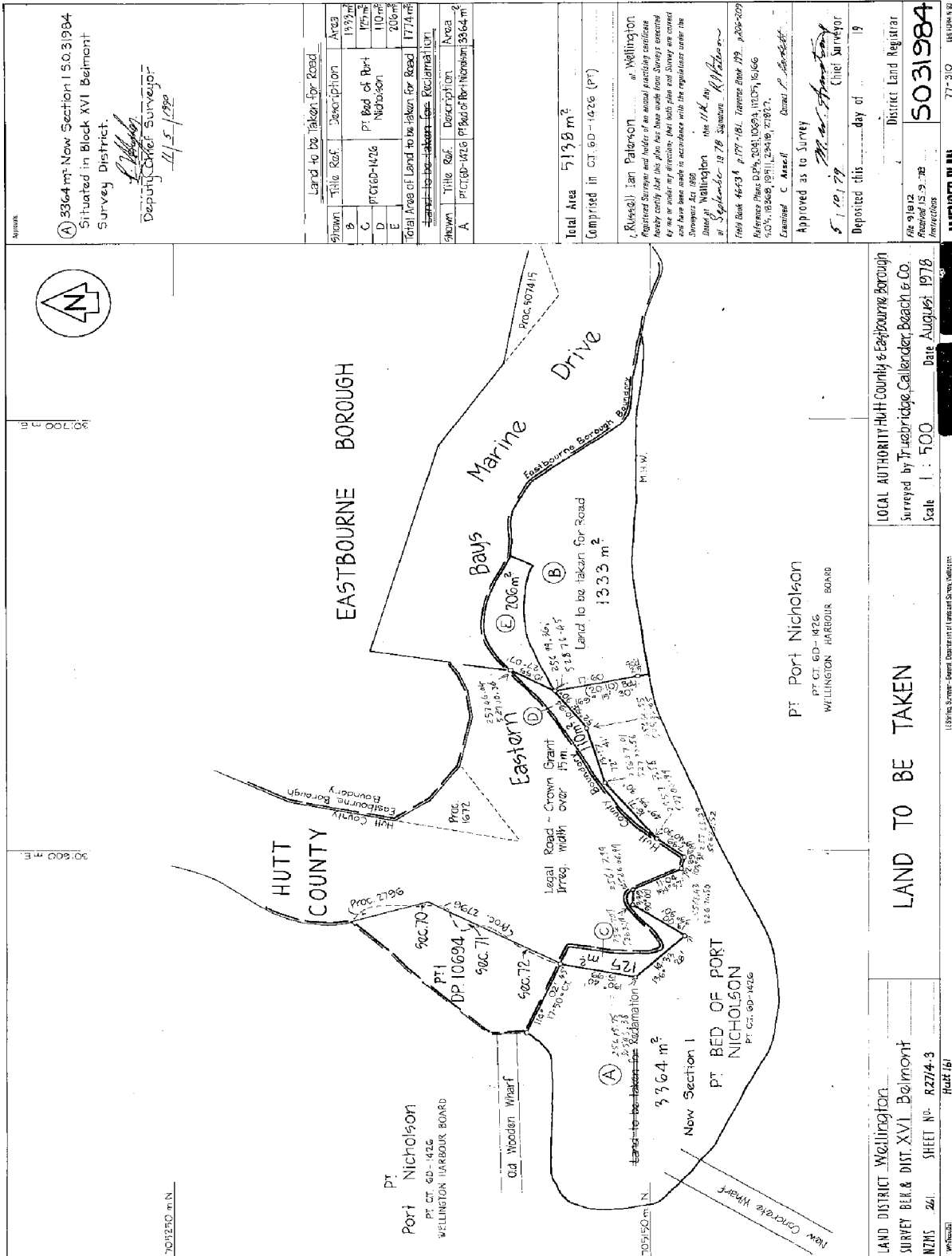

336.4 m² New Section 1 S.O. 31984
Situating in Block XVI Belmont
Survey District.

[Signature]
Deputy Chief Surveyor
4/5/1978

Shown	Title Ref.	Description	Area
B	1975/12		175 m ²
C	PT 6D-1426	PT Bed of Port Nicholson	110 m ²
D			206 m ²
E			206 m ²

Total Area of Land to be taken for Road 1774 m²
~~Land to be taken for Reclamation~~

Shown	Title Ref.	Description	Area
A	PT 6D-1426	PT Bed of Port Nicholson	336.4 m ²

Total Area 5138 m²
Comprised in CT. 6D-1426 (PT)

Ian Paterson at Wellington
Registered Surveyor and holder of an annual practicing certificate
do hereby certify that this plan has been made from surveys conducted
by me or under my direction and that both plan and survey are correct
and have been made in accordance with the regulations under the
Surveyors Act 1966
Dated at Wellington this 11th day of September 1978
Ian Paterson

Approved as to Survey
5/10/78
Chief Surveyor

Deposited this 5th day of 1978
District Land Registrar
S.O. 31984
Received 15/9/78
Instructions

777-310 EASTBOURNE

LOCAL AUTHORITY Hutt County & Eastbourne Borough
Surveyed by Traebridge, Callender, Beach & Co.
Scale 1:500 Date August 1978

LAND TO BE TAKEN

LAND DISTRICT Wellington
SURVEY BEK & DIST. XVI Belmont
NZMS 241 SHEET N° R2714-3
Hutt 161

AMENDED PLAN

1/3 Scale Survey - General Department of Land and Survey, Wellington